

**Recommended P.C. Board Layout**  
SCALE 4:1

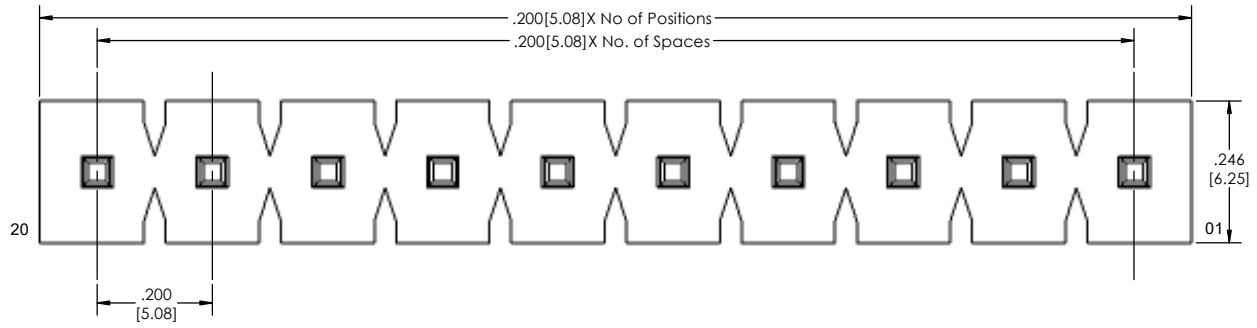
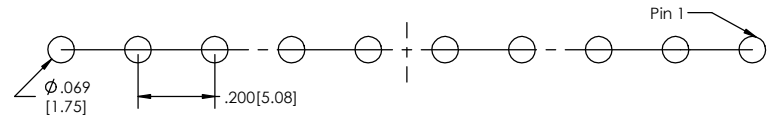
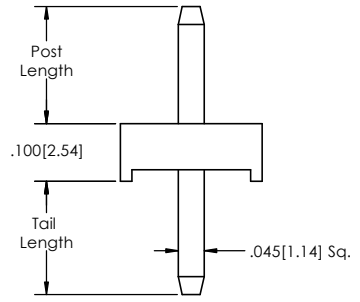

PC200H - [XX] - [S] - [XX] - [T] - [LF]  
(A) (B) (C) (D) (E)

- A. Pins Per Row - 1 through 20
- B. Row Specification - S= Single Row
- C. Pin Options - See Pin Options below
- D. Plating Options - See Plating Options below
- E. Lead Free

Mates with:  
PC200S-XX-S-02  
PC200S-XX-S-04

Pin Options		
Post Length	Tail Length	
.150[3.81mm]	.180[4.57mm]	01
.470[11.94mm]	.180[4.57mm]	02
.520[13.21mm]	.180[4.57mm]	04
.829[21.06mm]	.161[4.09mm]	14

Plating options	
T	Matte Tin all Over

**Specifications:**  
 Current Rating: 7.9 Ampere  
 Insulation Resistance: 5000M Ohms Min.  
 Dielectric Withstanding: 1500V AC  
 Contact Resistance: 20M Ohms Max.  
 Operation Temperature: -55°C to +125°C  
 Max. Process Temperature  
 IR Reflow: 280°C up to 10 secs.  
 Wave: 250°C up to 10 secs.  
 Manual Solder: 380°C up to 5 secs.

**Materials:**  
 Contact Material: Brass  
 Insulator Material: LCP, UL94V-0  
 Plating: 120µ" Matte Tine over 50µ"(1.27)Ni  
 Tails may be clipped to acheive specific dimensions.

Products cut to specific sizes are uncancellable/ nonreturnable.  
 Parts are subject to change without notice.



**PROPRIETARY AND CONFIDENTIAL**  
 THE INFORMATION CONTAINED IN THIS DRAWING IS THE SOLE PROPERTY OF Major League Electronics. ANY REPRODUCTION IN PART OR AS A WHOLE WITHOUT THE WRITTEN PERMISSION OF Major League Electronics IS PROHIBITED.

UNLESS OTHERWISE SPECIFIED:	
<b>DIMENSIONS ARE IN INCHES</b>	
<b>TOLERANCES:</b>	
ONE DECIMALS ±.100	
TWO DECIMAL ±.010	
THREE DECIMAL ±.002	
FOUR DECIMAL ±.002	
NEXT ASSY	USED ON
APPLICATION	DO NOT SCALE DRAWING

DRAWN	EOW	10/11/16
CHECKED	GWE	10/11/16
ENG APPR.		
MFG APPR.		
INTERPRET GEOMETRIC TOLERANCING PER:	ADDRESS:	
MATERIAL	2533 Centennial Blvd.	
FINISH	Jeffersonville, In 47130	
	Phone: 812-670-4174	
	Fax: 812-670-4175	
	E-Mail: mle@mlelectronics.com	

**TITLE:** PC200H Series

SIZE	DWG. NO.	REV
C		B

SCALE 6:1 SHEET 1 OF 1